

# Nutcracker On Ice

Centennial Skating Club is proud to present our 3rd Annual production of “NUTCRACKER ON ICE” Skate-tacular. There will be two shows: Saturday, **December 18<sup>th</sup>**, at 2:30 and 6:30PM. Participation in the show is open to Full and Associate members of CSC (role priority), and currently enrolled Sertich LTS skaters; non-members will be allowed to skate (if space permits) with an additional fee of \$35 to the registration fee. Registration Fees are as follows:

## REGISTRATION FEE

<i>Centennial SC Member [Full or Associate] (first family member).....</i>	<i>\$60</i>
<i>Registered Sertich LTS Skater (first family member).....</i>	<i>\$60</i>
<i>Non-Sertich LTS Skater (first family member).....</i>	<i>\$95</i>
<i>Non-Centennial SC Member (first family member).....</i>	<i>\$95</i>
<i>Each additional family member.....</i>	<i>\$30</i>
<i>Additional Production Number (Power or Dance) (optional).....</i>	<i>\$10</i>

*Registration Fees help cover ice and auditorium rental costs, set costs, group costuming costs, credentials, makeup, etc. The fees also include one production DVD per family, one cast member program, and one cast member Star.*

**Casting/Roles:** Roles will be determined by the CSC coaching staff and posted at Sertich on the CSC Board and online at [www.CentennialSkatingClub.org](http://www.CentennialSkatingClub.org) by **Monday, 10/4, at 8:00am**. *Soloists and Featured Small Groups* will be determined among skaters that have passed at least the Pre-Preliminary (Adult Bronze) MIF Test –**or**- Pre-Bronze Dances –**and**- at least the Freeskate 2 LTS level, **and** must have competed in Colorado Springs Invitational (CSI) 2010. Centennial skaters participating in 2010 Regionals, Adult Nationals, National Showcase, or are graduating seniors will be provided *SOLO* roles.

Basic Skills and Freeskate levels will be given parts in *Group Numbers* in the following sequence (with limited numbers per level/per group on first come first served basis):

Snowplow 1-3 – The Gingerbread (with Mother Ginger) (max. 16 skaters)

Basic 1-4 – Mice Army (Rat King/Queen) (max. 16 skaters)

Basic 5-8 – Soldier Army (with Nutcracker Soldier) (max. 16 skaters)

Freeskate 1-6 – Party Guests & Family (max. 30 skaters)

Adult Skills 1-8 & Adult Freeskate 1-6 – Parents’ Waltz (& Dance Gala) (max. 20 skaters)

**Production Numbers:** There will be two Production Numbers – POWER & DANCE. These performances are open to skaters Basic 8 and higher (and at least 8 years of age). A skater may participate in either Power or Dance, but not both. If a skater is chosen to perform a solo or featured group, and that skater has signed up for

# Nutcracker On Ice

a Production Number, that skater will automatically be placed in Snowflakes or Flowers – depending on their role selected. Each Production Number is limited to max. 22 skaters.

POWER - Waltz of the Snowflakes (must have participated in Sertich Power Class in past year, *or* have passed the Pre-Preliminary MIF Test)

DANCE – Waltz of the Flowers

**Music:** >Soloists will receive an already cut version of their role’s music. Choreography can be done by the skater and/or coach. It is recommended to have a coach oversee its development.

>Featured Small Groups will receive an already cut version of their role’s music. Choreography can be done by the skaters and/or coach(es). It is recommended to have a coach oversee its development.

>LTS Skills Groups will practice their routines during rehearsals only. Choreography will be done by NOI assigned coach, NOT by skater’s coach.

**Costume(s):** Costumes will be supplied to Group and Production Numbers. \*Skaters may be required to purchase items such as tights, leotards, or other personal items.\* Soloists and Featured Small Groups are responsible for their own costumes. Costumes must be approved by NOI Director, Dianna-lynn Wells.

**Costume Information:** Soloists and Small Groups are responsible for their own costumes, and must be approved by NOI Director, Dianna-lynn Wells. LTS Skills Groups -&- Production Numbers are as follows:

>Snowplow 1-3 – Gingerbread costume will be provided. Skaters are responsible for following extra clothing: Undershirt and tights (boys as well).

>Basic 1-8 – Soldiers & Mice costume will be provided. Skaters are responsible for following extra clothing:

- Mice – Undershirts and tights to go under the costume.
- Soldiers – Undershirts and Solid Black pants/slacks (girls included) (NO denim).

>POWER – snowflake effect will be provided (skirt, arm bands, hair accessories, etc.). Skaters are responsible for following extra clothing:

- Ladies – white matte leotard (withOUT sleeves) and NEW nude tights. White leotards & tights can be purchased from the NOI Director during rehearsals - NO BOOTCOVERS or OTB tights.
- Gentlemen – white matte dress shirt (with sleeves) and black pants/slacks that secure to skates. NO BOOTCOVERS.

>DANCE – waltz of the flowers effect will be provided (skirt, hair & arm accessories). Skaters are responsible for following extra clothing:

- Ladies – white matte leotard (withOUT sleeves) NEW nude tights. White leotards & tights can be purchased from the NOI Director during any of the rehearsals - NO BOOTCOVERS or OTB tights.
- Gentlemen – white matte dress shirt (with sleeves) and black pants/slacks that secure to skates. NO BOOTCOVERS.

# Nutcracker On Ice

**Registration Form:** Registration forms are available NOW at Sertich Ice Center, and online at [www.CentennialSkatingClub.org](http://www.CentennialSkatingClub.org), starting Monday, September 20<sup>th</sup> at 9AM. The registration deadline is “DUE in HAND” Thursday, September 30<sup>th</sup>, 2010; “postmarked” by 9/27/2010.

**Rehearsals:** Rehearsal dates are listed below. Rehearsals will begin Sunday, October 10<sup>th</sup> and run once a week with a duration of up to 3 hours. There is a **mandatory** off-ice dress rehearsal 12/12 from 1:30pm – 4:30pm at Main Auditorium. I do understand that things come up last minute, however, if more than three of our nine rehearsals are to be missed, the skater will be asked to resign from the show without a refund.

Dress Warm—when we have on-ice rehearsals, wear layers of clothing in order to stay warm. The rehearsals will NOT be active freestyle sessions and skaters can get very cold, very quickly. Drinks and food will NOT be allowed on the ice during rehearsals (except water/sports drinks). There *will be* off-ice rehearsals held at the City Auditorium (Main Stage) at: *221 East Kiowa St., between Weber & Nevada (Kiowa is on North end of Theatre)*. *Food and drinks will NOT be allowed in Main Auditorium. We will lose use of Main Auditorium if physical damage or waste is left after our rehearsals.* A building layout is provided on the next page.

10/10/2010	Sun	Sertich Ice Center	9:45am - 11:15am
10/17/2010	Sun	Sertich Ice Center	9:45am - 11:15am
10/24/2010	Sun	Sertich Ice Center	9:45am - 11:15am
10/31/2010	Sun	Sertich Ice Center	9:45am - 11:15am
11/5/2010	Fri	Main Auditorium	5:15pm – 8:15pm
11/13/2010	Sat	Main Auditorium	11:30am - 1:30pm
11/21/2010	Sun	Main Auditorium	3:30pm – 6:30pm
<b>**11/25 – 28/2010**</b>		<b>*****THANKSGIVING WEEKEND*****No Rehearsals.</b>	
12/5/2010	Sun	Sertich Ice Center	9:45am - 11:15am
12/11/2010	Sat	Main Auditorium	11:00am – 1:00pm
12/12/2010	Sun	Main Auditorium	<u>1:30pm - 4:30pm</u> (Off-ice Dress Rehearsal)
12/18/2010	Sat	Sertich Ice Center	<u>9:15am – 11:00pm</u> (Shows: 2:30 & 6:30 PM)

# Nutcracker On Ice



Floor Plan (City Auditorium) - 221 East Kiowa St., between Weber & Nevada (Kiowa is on North end of Theatre)

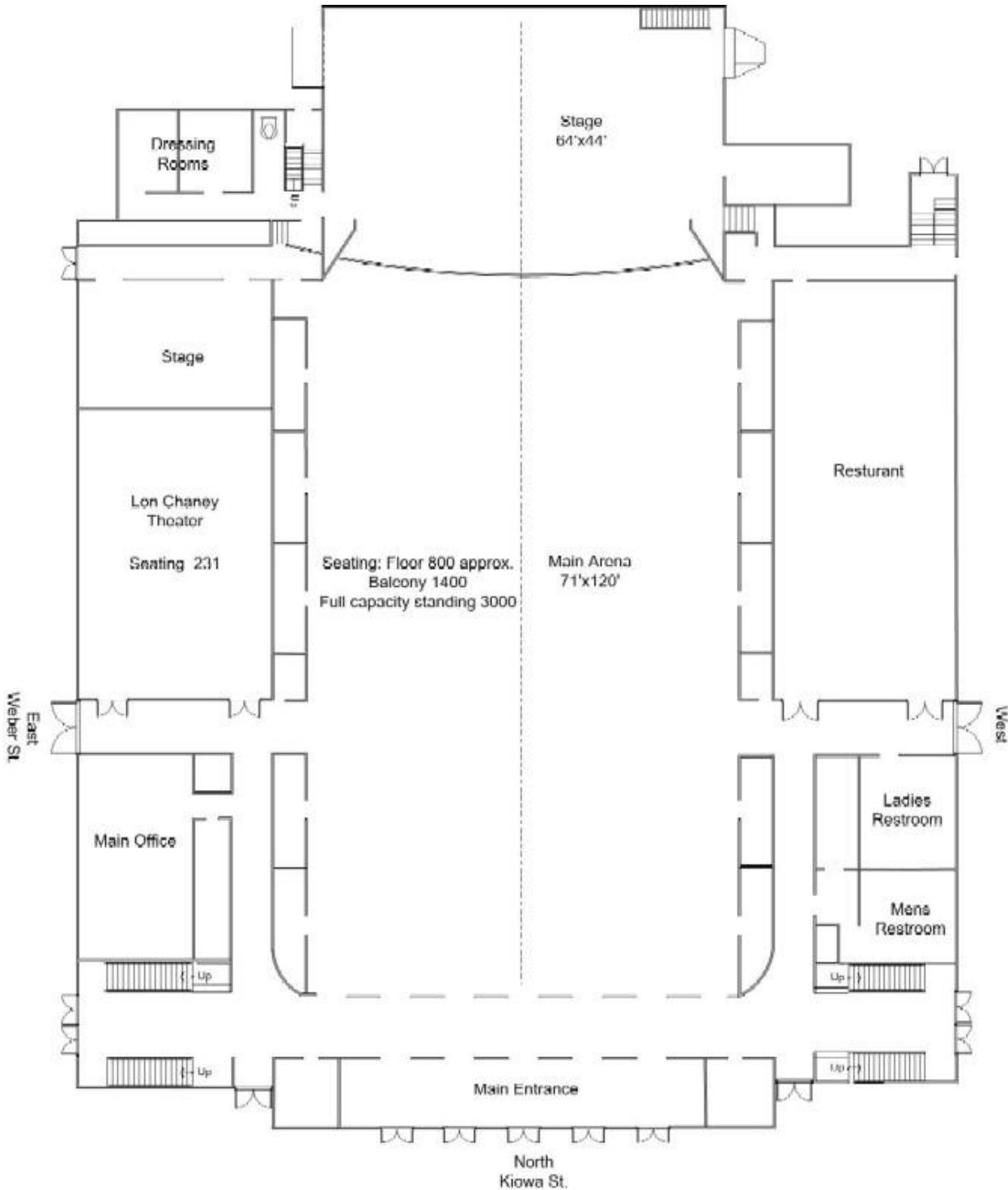

**Additional Information:** Contact Dianna-lynn Wells, [Sk8Pro@DiannalynneSpin.com](mailto:Sk8Pro@DiannalynneSpin.com), 719.761.0452.